

TRUE METAL SOLUTIONS

PEAL[®] Steel Fittings

(Black and Galvanised)



Edition 3

Specifications

British Standard Threads							
All measurements in mm							
NOMINAL BORE OF PIPE		APPROX. OUTSIDE DIAMETER	NUMBER OF THREADS PER INCH	PITCH	DEPTH OF THREADS	DIAMETER AT GAUGE PLANE	LENGTH OF USEFUL THREAD
IMPERIAL	METRIC	A		P	h	B	E
1/8	6	10.16	28	0.907	0.581	9.72	6.5
1/4	8	13.66	19	1.337	0.856	13.15	9.7
3/8	10	17.17	19	1.337	0.856	16.66	10.1
1/2	15	21.51	14	1.814	1.162	20.95	13.2
3/4	20	27.00	14	1.814	1.162	26.44	14.5
1	25	33.93	11	2.309	1.479	33.24	16.8
1 1/4	32	42.59	11	2.309	1.479	41.91	19.1
1 1/2	40	48.48	11	2.309	1.479	47.80	19.1
2	50	60.47	11	2.309	1.479	59.61	23.4
2 1/2	65	76.09	11	2.309	1.479	75.18	26.7
3	80	88.87	11	2.309	1.479	87.88	29.8
4	100	114.14	11	2.309	1.479	113.03	35.8
5	125	139.65	11	2.309	1.479	138.43	40.1
6	150	165.12	11	2.309	1.479	163.83	40.1

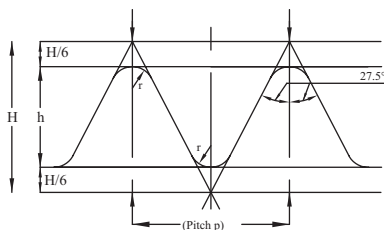

Fig. 1. (Parallel)
 $H = 0.960491 \times p$
 $h = 0.640327 \times p$
 $r = 0.137329 \times p$

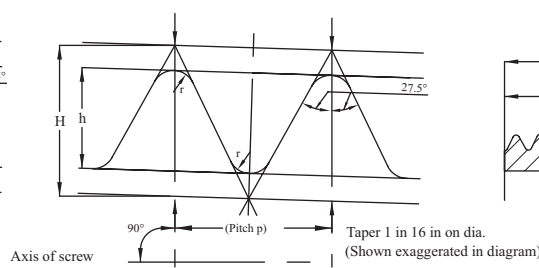

Fig. 2. (Taper)
 $H = 0.960237 \times p$
 $h = 0.640327 \times p$
 $r = 0.137278 \times p$

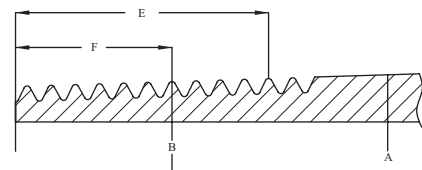

Fig. 3. (Taper)

Chemical Composition of Seamless Steel Fittings		
C MAX. (%)	S MAX. (%)	P MAX. (%)
0.25	0.35	0.09

Chemical Composition of Fabricated Fittings			
C MAX. (%)	Mn MAX. (%)	P MAX. (%)	S MAX. (%)
0.25	1.40	0.045	0.045

Mechanical Properties of Seamless Steel Fittings	
TENSILE STRENGTH MIN. (N/mm2)	ELONGATION MIN. (%)
320	20

Mechanical Properties of Fabricated Fittings		
TENSILE STRENGTH MIN. (N/mm2)	YEILD STRENGTH MIN. (N/mm2)	ELONGATION MIN. (%)
320	195	20

STEEL THREADED PIPE FITTINGS MANUFACTURED ACCORDING TO THE BS EN 10241:2000 STANDARD.
 NORMATIVE REFERENCES: EN 10204, EN ISO 6708, ISO 7-1 PART 1, ISO 7-2, PART 2, AS 1074.



Black & Galvanised Steel Unions - Taper Threads

Peal® Steel Unions

Black steel unions are used in a wide range of make-and-break joints such as: filters, valves, hoses, machinery and general piping installations requiring periodic disconnections. They are particularly suited to high or low pressure assemblies in air, oil, gas and water. They are available in Steel-Steel, Steel-Bronze and Bronze-Bronze seats with Female-Female and Male-Female end connections.



Zinc-Coated Unions

These unions are electro zinc plated and are available in Steel-Steel, Steel-Bronze and Bronze-Bronze seats with Female-Female and Male-Female end connections. This process gives a complete coating both externally and internally which protects the pipe union at the thread and vital seating areas. They are particularly suitable where there is condensation, such as in air and gas lines. The zinc coating also gives an outside protective coating against rust when exposed to the atmosphere. (The Steel-Steel zinc coated union is an ideal union suitable for most applications where vibration and moisture are present, such as compressed air lines and railway breaking systems)



Seating Specifications

Ball to Cone Seating in the following combinations:-

STEEL – STEEL (SS)

This is a general purpose combination recommended where vibration is present. The seats are integral and therefore are the most economically priced. This union will suit almost any application. Zinc coating improves the corrosion resistance of the joints to a marked degree where corrosion is present.

STEEL – BRONZE (SB)

A good seat combination where corrosion due to the fluid medium that is being used in the line or where condensation is present and when periodic disconnection is required. Zinc coating improves the corrosion resistance of the joints to a marked degree where corrosion is present.

BRONZE – BRONZE (BB)

This seat combination is recommended when corrosion due to the fluid medium in the pipe line or condensation is a major factor and where constant disconnection is required.

This seat combination is ideally suited to steam lines. Zinc coating improves the corrosion resistance of the joints to a marked degree where corrosion is present.

END CONNECTION THREADING

- Taper threads only.

External (R) and internal (RC) series to AS 1722 Part 1.

AAP Steel Fittings are pressure tested by application of internal pressure, under which they are required to withstand, without signs of leakage, failure, or plastic deformation, the following tests

*All sizes of unions up to 2" nominal bore individually tested to 13.8MPa and sample tested to 20.7MPa

*All sizes of unions over 2" nominal bore individually tested to 10.3MPa

* All sizes of ordinary sockets sample tested to 5.2MPa

*All sizes of other fittings sample tested to 5.2MPa

Dimensions - mm											
DN	8	10	15	20	25	32	40	50	65	80	100
A*	56	57	66	77	84	98	110	116	138	154	165
B	35	35	42	52	61	76	83	101	120	136	163
C	21	21	26	34	40	50	56	70	86	103	127
E*	42	42	46	54	61	71	82	88	108	119	121

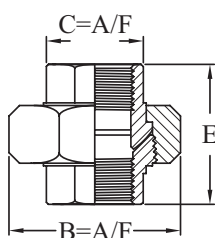

- NOTES: 1. Dimension B-Nut is Hexagon up to DN 25
Nut is Octagon DN 32 and larger.
2. Dimension C-Body Flats are all Octagon.
3.* Dimensions A & E are approximately Overall length in mm.

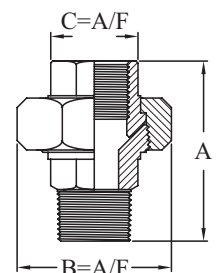

PEAL® Black & Galvanised Mild Steel Female-Female Union

Seats Available: Steel-Steel,
Steel-Bronze, Bronze-Bronze
All Unions have BSPT thread



Black & Galvanised Mild Steel Female-Female Union						
AAP CODE		IMPERIAL SIZE	A	ACROSS FLATS		APPROX. (KG/PC)
BLACK	GALVANISED			B	C	
SU08BB	SU08BBG	1/4	42	35	21	0.16
SU08SB	SU08SBG	1/4	42	35	21	0.16
SU08SS	SU08SSG	1/4	42	35	21	0.16
SU10BB	SU10BBG	3/8	42	35	21	0.14
SU10SB	SU10SBG	3/8	42	35	21	0.14
SU10SS	SU10SSG	3/8	42	35	21	0.14
SU15BB	SU15BBG	1/2	46	42	26	0.23
SU15SB	SU15SBG	1/2	46	42	26	0.23
SU15SS	SU15SSG	1/2	46	42	26	0.23
SU20BB	SU20BBG	3/4	54	52	34	0.41
SU20SB	SU20SBG	3/4	54	52	34	0.41
SU20SS	SU20SSG	3/4	54	52	34	0.41
SU25BB	SU25BBG	1	61	61	40	0.59
SU25SB	SU25SBG	1	61	61	40	0.58
SU25SS	SU25SSG	1	61	61	40	0.58
SU32BB	SU32BBG	1 1/4	71	76	50	0.91
SU32SB	SU32SBG	1 1/4	71	76	50	0.90
SU32SS	SU32SSG	1 1/4	71	76	50	0.90
SU40BB	SU40BBG	1 1/2	82	83	56	1.28
SU40SB	SU40SBG	1 1/2	82	83	56	1.28
SU40SS	SU40SSG	1 1/2	82	83	56	1.28
SU50BB	SU50BBG	2	88	101	70	2.01
SU50SB	SU50SBG	2	88	101	70	2.01
SU50SS	SU50SSG	2	88	101	70	2.00
SU65BB	SU65BBG	2 1/2	108	120	86	3.59
SU65SB	SU65SBG	2 1/2	108	120	86	3.59
SU65SS	SU65SSG	2 1/2	108	120	86	3.59
SU80BB	SU80BBG	3	119	136	103	4.98
SU80SB	SU80SBG	3	119	136	103	4.98
SU80SS	SU80SSG	3	119	136	103	4.98
SU94BB	SU94BBG	4	121	163	127	6.55
SU94SB	SU94SBG	4	121	163	127	6.55
SU94SS	SU94SSG	4	121	163	127	6.55

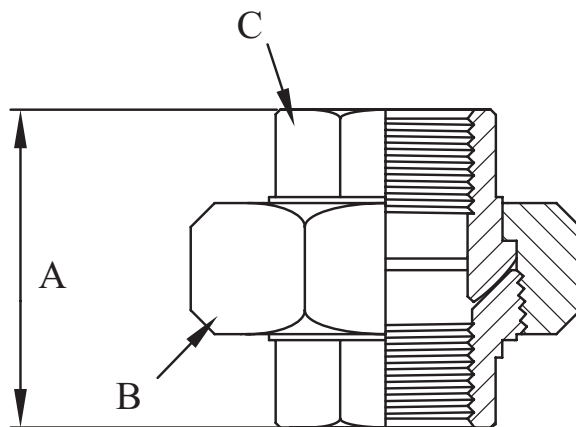

PEAL® Black & Galvanised Mild Steel Male-Female Union

Black & Galvanised Mild Steel Male-Female Union						
AAP CODE		IMPERIAL SIZE	A	ACROSS FLATS		APPROX. (KG/PC)
BLACK	GALVANISED			B	C	
SU08MFBB	SU08MFBBG	1/4	56	35	21	0.18
SU08MFBS	SU08MFBSG	1/4	56	35	21	0.18
SU08MFSS	SU08MFSSG	1/4	56	35	21	0.18
SU10MFBB	SU10MFBBG	3/8	57	35	21	0.17
SU10MFBS	SU10MFBSG	3/8	57	35	21	0.17
SU10MFSS	SU10MFSSG	3/8	57	35	21	0.17
SU15MFBB	SU15MFBBG	1/2	66	42	26	0.28
SU15MFBS	SU15MFBSG	1/2	66	42	26	0.28
SU15MFSS	SU15MFSSG	1/2	66	42	26	0.28
SU20MFBB	SU20MFBBG	3/4	77	52	34	0.47
SU20MFBS	SU20MFBSG	3/4	77	52	34	0.47
SU20MFSS	SU20MFSSG	3/4	77	52	34	0.47
SU25MFBB	SU25MFBBG	1	84	61	40	0.67
SU25MFBS	SU25MFBSG	1	84	61	40	0.67
SU25MFSS	SU25MFSSG	1	84	61	40	0.67
SU32MFBB	SU32MFBBG	1 1/4	98	76	50	1.11
SU32MFBS	SU32MFBSG	1 1/4	98	76	50	1.11
SU32MFSS	SU32MFSSG	1 1/4	98	76	50	1.11
SU40MFBB	SU40MFBBG	1 1/2	110	83	56	1.42
SU40MFBS	SU40MFBSG	1 1/2	110	83	56	1.42
SU40MFSS	SU40MFSSG	1 1/2	110	83	56	1.42
SU50MFBB	SU50MFBBG	2	116	101	70	2.32
SU50MFBS	SU50MFBSG	2	116	101	70	2.32
SU50MFSS	SU50MFSSG	2	116	101	70	2.32
SU65MFBB	SU65MFBBG	2 1/2	138	120	86	4.21
SU65MFBS	SU65MFBSG	2 1/2	138	120	86	4.21
SU65MFSS	SU65MFSSG	2 1/2	138	120	86	4.20
SU80MFBB	SU80MFBBG	3	154	136	103	5.97
SU80MFBS	SU80MFBSG	3	154	136	103	5.97
SU80MFSS	SU80MFSSG	3	154	136	103	5.97

Seats Available: Steel-Steel, Steel-Bronze, Bronze-Bronze
All Unions have BSPT thread

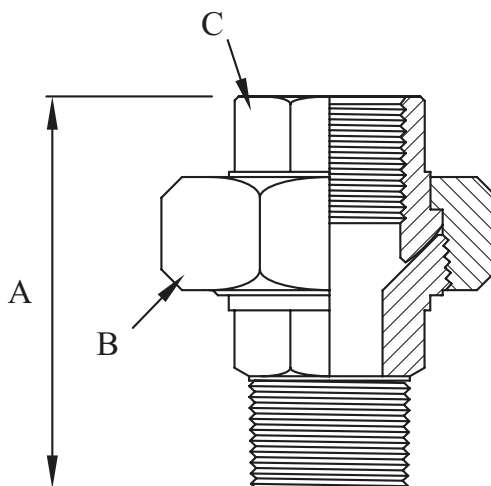

PEAL® Black Mild Steel Female-Female Barrel Union

Seats Available: Steel-Steel



Black Mild Steel Female-Female Barrel Union					
AAP CODE BLACK	IMPERIAL SIZE	A	ACROSS FLATS	C	APPROX. (KG/PC)
			B		
SUB25SS	1	61	61	40	0.58
SUB32SS	1 1/4	71	76	50	0.90
SUB40SS	1 1/2	82	83	56	1.28

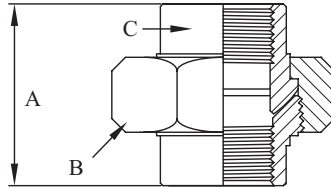

PEAL® Black & Galvanised Mild Steel Female-Female Elbow

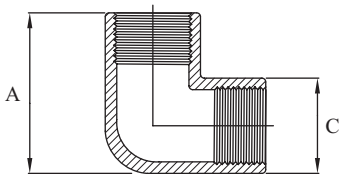

Black & Galvanised Mild Steel Female-Female Elbow					
AAP CODE		IMPERIAL SIZE	A	C	APPROX. (KG/PC)
BLACK	GALVANISED				
SE06	SE06G	1/8	32	19	0.08
SE08	SE08G	1/4	32	19	0.06
SE10	SE10G	3/8	36	22	0.08
SE15	SE15G	1/2	46	28	0.17
SE20	SE20G	3/4	53	34	0.24
SE25	SE25G	1	66	42	0.43
SE32	SE32G	1 1/4	76	50	0.63
SE40	SE40G	1 1/2	86	58	0.97
SE50	SE50G	2	98	69	1.32
SE65	SE65G	2 1/2	114	83	1.55
SE80	SE80G	3	138	97	2.57
SE94	SE94G	4	179	124	4.41
SE96		6	250	178	13.0

PEAL® Black & Galvanised Mild Steel Female-Female 45 Degree Elbow

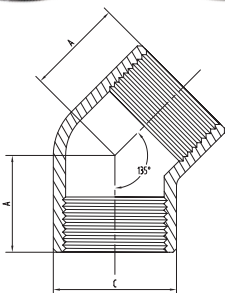

Black & Galvanised Mild Steel Female-Female 45 Degree Elbow					
AAP CODE		IMPERIAL SIZE	A	C	APPROX. (KG/PC)
BLACK	GALVANISED				
SEF15	SEF15G	1/2	22	28	0.13
SEF20	SEF20G	3/4	27	34	0.18
SEF25	SEF25G	1	33	42	0.32
SEF32	SEF32G	1 1/4	38	50	0.46
SEF40	SEF40G	1 1/2	44	58	0.72
SEF50	SEF50G	2	51	69	0.98
SEF65	SEF65G	2 1/2	59	83	1.15
SEF80	SEF80G	3	66	97	1.90
SEF94	SEF94G	4	77	124	3.27
SE65	SE65G	2 1/2	114	83	1.55
SE80	SE80G	3	138	97	2.57
SE94	SE94G	4	179	124	4.41



PEAL® Black & Galvanised Mild Steel Male-Female Elbow

Black & Galvanised Mild Steel Male-Female Elbow					
AAP CODE		IMPERIAL SIZE	A	C	APPROX (KG/PC)
BLACK	GALVANISED				
SEMF08	SEMF08G	1/4	40	19	0.05
SEMF10	SEMF10G	3/8	44	22	0.07
SEMF15	SEMF15G	1/2	58	28	0.17
SEMF20	SEMF20G	3/4	67	34	0.22
SEMF25	SEMF25G	1	70	43	0.35
SEMF32	SEMF32G	1 1/4	90	50	0.61
SEMF40	SEMF40G	1 1/2	97	57	0.82
SEMF50	SEMF50G	2	115	70	1.15
SEMF65	SEMF65G	2 1/2	150	89	2.09
SEMF80	SEMF80G	3	160	98	2.48
SEMF94	SEMF94G	4	187	126	4.45

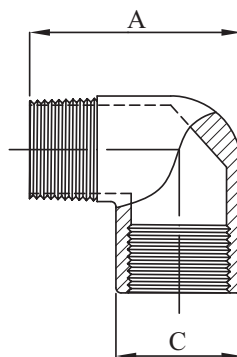

PEAL® Black & Galvanised Mild Steel Hexagon Nipple (Equal)

Black & Galvanised Mild Steel Hexagon Nipple (Equal)					
AAP CODE		IMPERIAL SIZE	A	ACROSS FLATS	APPROX. (KG/PC)
BLACK	GALVANISED			B	
SN06	SN06G	1/8	27	11	0.01
SN08	SN08G	1/4	33	16	0.03
SN10	SN10G	3/8	34	19	0.04
SN15	SN15G	1/2	46	22	0.07
SN20	SN20G	3/4	47	27	0.08
SN25	SN25G	1	52	35	0.13
SN32	SN32G	1 1/4	61	47	0.27
SN40	SN40G	1 1/2	61	52	0.31
SN50	SN50G	2	68	61	0.48
SN65	SN65G	2 1/2	79	79	0.77
SN80	SN80G	3	88	92	1.35
SN94	SN94G	4	101	117	2.32

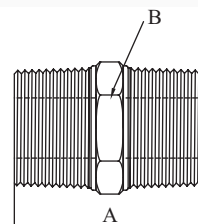

PEAL® Black & Galvanised Mild Steel Hexagon Reducing Nipple

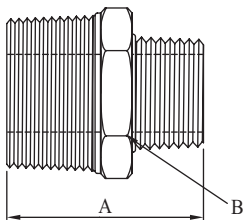

Black & Galvanised Mild Steel Hexagon Reducing Nipple					
AAP CODE		IMPERIAL SIZE	A	ACROSS FLATS	APPROX. (KG/PC)
BLACK	GALVANISED			B	
SN0806	SN0806G	1/4 X 1/8	30	16	0.02
SN1006	SN1006G	3/8 X 1/8	31	19	0.03
SN1008	SN1008G	3/8 X 1/4	34	19	0.04
SN1508	SN1508G	1/2 X 1/4	40	22	0.05
SN1510	SN1510G	1/2 X 3/8	40	22	0.06
SN2010	SN2010G	3/4 X 3/8	42	27	0.07
SN2015	SN2015G	3/4 X 1/2	47	27	0.09
SN2515	SN2515G	1 X 1/2	50	35	0.13
SN2520	SN2520G	1 X 3/4	50	35	0.13
SN3220	SN3220G	1 1/4 X 3/4	55	47	0.25
SN3225	SN3225G	1 1/4 X 1	57	47	0.24
SN4020	SN4020G	1 1/2 X 3/4	57	52	0.32
SN4025	SN4025G	1 1/2 X 1	59	52	0.30
SN4032	SN4032G	1 1/2 X 1 1/4	63	52	0.34
SN5020	SN5020G	2 X 3/4	60	61	0.41
SN5025	SN5025G	2 X 1	62	61	0.52
SN5032	SN5032G	2 X 1 1/4	66	61	0.51
SN5040	SN5040G	2 X 1 1/2	66	61	0.49
SN6540	SN6540G	2 1/2 X 1 1/2	73	79	0.87
SN6550	SN6550G	2 1/2 X 2	74	79	0.75
SN8050	SN8050G	3 X 2	81	92	1.25
SN8065	SN8065G	3 X 2 1/2	85	92	1.15
SN9450	SN9450G	4 X 2	88	115	2.20
SN9480	SN9480G	4 X 3	96	115	2.34

PEAL® Black & Galvanised Mild Steel Socket (Type Heavy)

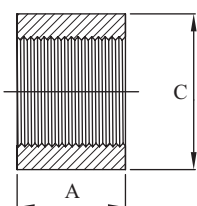
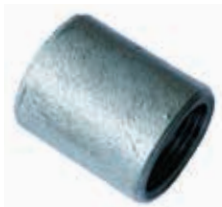

Black & Galvanised Mild Steel Socket (Type Heavy)					
AAP CODE		IMPERIAL SIZE	A	C	APPROX. (KG/PC)
BLACK	GALVANISED				
SS06	SS06G	1/8	19.3	15.6	0.01
SS08	SS08G	1/4	27.0	18.5	0.03
SS10	SS10G	3/8	28.0	22.0	0.04
SS15	SS15G	1/2	37.0	27.0	0.07
SS20	SS20G	3/4	39.0	32.5	0.09
SS25	SS25G	1	46.0	39.5	0.15
SS32	SS32G	1 1/4	51.0	49.0	0.22
SS40	SS40G	1 1/2	51.0	56.0	0.29
SS50	SS50G	2	60.0	68.0	0.44
SS65	SS65G	2 1/2	69.0	84.0	0.67
SS80	SS80G	3	75.0	98.0	0.96
SS94	SS94G	4	87.0	124.0	1.55
SS95	SS95G	5	96.0	151.0	2.37
SS96	SS96G	6	96.0	178.0	3.03



PEAL® Black & Galvanised Mild Steel Reducing Socket

Black & Galvanised Mild Steel Reducing Socket						
AAP CODE		IMPERIAL SIZE	A	C	D	APPROX. (KG/PC)
BLACK	GALVANISED					
SS0806	SS0806G	1/4 X 1/8	25	15	19	0.03
SS1008	SS1008G	3/8 X 1/4	27	19	22	0.04
SS1508	SS1508G	1/2 X 1/4	36	22	28	0.08
SS1510	SS1510G	1/2 X 3/8	36	22	28	0.08
SS2008	SS2008G	3/4 X 1/4	39	30	34	0.16
SS2010	SS2010G	3/4 X 3/8	39	30	34	0.15
SS2015	SS2015G	3/4 X 1/2	39	30	34	0.14
SS2510	SS2510G	1 X 3/8	47	31	41	0.22
SS2515	SS2515G	1 X 1/2	47	31	41	0.2
SS2520	SS2520G	1 X 3/4	47	31	41	0.2
SS3220	SS3220G	1 1/4 X 3/4	57	38	50	0.36
SS3225	SS3225G	1 1/4 X 1	57	44	50	0.35
SS4020	SS4020G	1 1/2 X 3/4	60	38	57	0.43
SS4025	SS4025G	1 1/2 X 1	60	44	57	0.43
SS4032	SS4032G	1 1/2 X 1 1/4	60	50	57	0.4
SS5020	SS5020G	2 X 3/4	63	38	69	0.6
SS5025	SS5025G	2 X 1	63	44	69	0.6
SS5032	SS5032G	2 X 1 1/4	63	50	69	0.6
SS5040	SS5040G	2 X 1 1/2	63	57	69	0.6
SS6540	SS6540G	2 1/2 X 1 1/2	69	57	88	1
SS6550	SS6550G	2 1/2 X 2	69	69	88	1
SS8025	SS8025G	3 X 1	79	44	101	1.5
SS8050	SS8050G	3 X 2	79	69	101	1.25
SS8065	SS8065G	3 X 2 1/2	79	88	101	1.26
SS9450	SS9450G	4 X 2	84	69	127	2.2
SS9465	SS9465G	4 X 2 1/2	84	88	127	2.48
SS9480	SS9480G	4 X 3	84	101	127	2.14

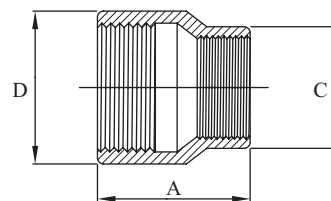

PEAL® Black Mild Steel Half Socket (Type Heavy)

Black Mild Steel Half Socket (Type Heavy)				
AAP CODE	IMPERIAL SIZE	A	C	APPROX. (KG/PC)
SSH10	3/8	12.2	22.0	0.02
SSH15	1/2	16.0	27.0	0.03
SSH20	3/4	19.1	32.5	0.04
SSH25	1	21.1	39.5	0.06
SSH32	1 1/4	28.1	49.0	0.11
SSH40	1 1/2	25.3	56.0	0.17
SSH50	2	28.3	68.0	0.20
SSH65	2 1/2	30.6	84.0	0.38
SSH80	3	35.7	98.0	0.43
SSH94	4	40.4	124.0	0.80

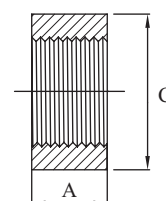

PEAL® Black Mild Steel Profile Socket Black Mild Steel Profile Socket

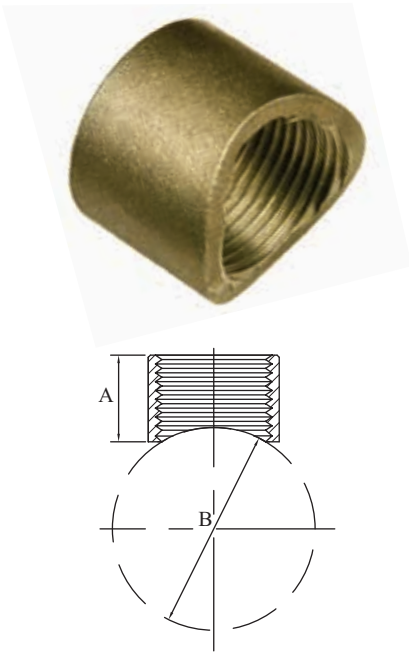

Black Mild Steel Profile Socket				
AAP CODE	IMPERIAL SIZE	A	B (DIA.)	APPROX (KG/PC)
SSP2525	1	35	33.7	0.10
SSP2532	1	33.5	42.4	0.10
SSP2540	1	32.47	48.3	0.10
SSP2550	1	31.21	60.3	0.10
SSP2565	1	30.28	76	0.10
SSP2580	1	29.79	88.9	0.10
SSP2594	1	29.18	114	0.10
SSP2596	1	28.54	165.1	0.10
SSP3232	1 1/4	38	42.4	0.14
SSP3240	1 1/4	36.96	48.3	0.14
SSP3250	1 1/4	34.24	60.3	0.14
SSP3265	1 1/4	32.48	76	0.14
SSP3280	1 1/4	31.61	88.9	0.14
SSP3294	1 1/4	30.55	114	0.14
SSP3296	1 1/4	30.45	165.1	0.14
SSP4040	1 1/2	41.5	48.3	0.19
SSP4050	1 1/2	37.6	60.3	0.19
SSP4065	1 1/2	34.93	76	0.19
SSP4080	1 1/2	33.69	88.9	0.19
SSP4094	1 1/2	32.22	114	0.19
SSP4096	1 1/2	30.73	165.1	0.19
SSP5050	2	48.1	60.3	0.23
SSP5065	2	41.11	76	0.23
SSP5080	2	38.64	88.9	0.23
SSP5094	2	35.99	114	0.23
SSP5096	2	33.47	165.1	0.23

PEAL® Black Mild Steel Pap

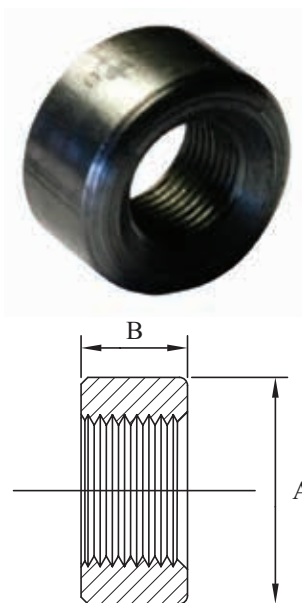

Black Mild Steel Pap				
AAP CODE	SIZE IMPERIAL	A	B	APPROX. (KG/PC)
SSH10/15	3/8	28.57	15.75	0.05
SSH15S	1/2	28.57	15.75	0.04
SSH20S	3/4	35.75	20.64	0.07

PEAL® Black Mild Steel Hexagon Pap

Black Mild Steel Hexagon Pap				
AAP CODE	SIZE IMPERIAL	ACROSS FLATS	B	APPROX. (KG/PC)
		A		
SSH10SH	3/8	28.57	16	0.06
SSH15SH	1/2	28.57	16	0.04

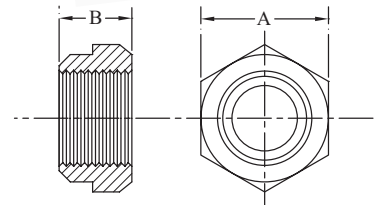

PEAL® Black & Galvanised Mild Steel Hexagon Bush

Black & Galvanised Mild Steel Hexagon Bush					
AAP CODE		IMPERIAL SIZE	A	ACROSS FLATS	APPROX (KG/PC)
BLACK	GALVANISED			B	
SB0806	SB0806G	1/4 X 1/8	20	15	0.01
SB1006	SB1006G	3/8 X 1/8	21	19	0.02
SB1008	SB1008G	3/8 X 1/4	21	19	0.02
SB1508	SB1508G	1/2 X 1/4	27	22	0.04
SB1510	SB1510G	1/2 X 3/8	27	22	0.03
SB2008	SB2008G	3/4 X 1/4	28	27	0.07
SB2010	SB2010G	3/4 X 3/8	28	27	0.06
SB2015	SB2015G	3/4 X 1/2	28	27	0.05
SB2508	SB2508G	1 X 1/4	30	35	0.13
SB2510	SB2510G	1 X 3/8	30	35	0.12
SB2515	SB2515G	1 X 1/2	30	35	0.11
SB2520	SB2520G	1 X 3/4	30	35	0.26
SB3215	SB3215G	1 1/4 X 1/2	36	47	0.25
SB3220	SB3220G	1 1/4 X 3/4	36	47	0.24
SB3225	SB3225G	1 1/4 X 1	36	47	0.19
SB4015	SB4015G	1 1/2 X 1/2	38	52	0.33
SB4020	SB4020G	1 1/2 X 3/4	38	52	0.30
SB4025	SB4025G	1 1/2 X 1	38	52	0.25
SB4032	SB4032G	1 1/2 X 1 1/4	38	52	0.17
SB5015	SB5015G	2 X 1/2	41	61	0.50
SB5020	SB5020G	2 X 3/4	41	61	0.50
SB5025	SB5025G	2 X 1	41	61	0.43
SB5032	SB5032G	2 X 1 1/4	41	61	0.41
SB5040	SB5040G	2 X 1 1/2	41	61	0.35
SB6540	SB6540G	2 1/2 X 1 1/2	47	79	0.97
SB6550	SB6550G	2 1/2 X 2	47	79	0.68
SB8025	SB8025G	3 X 1	54	92	1.66
SB8040	SB8040G	3 X 1 1/2	54	92	1.46
SB8050	SB8050G	3 X 2	54	92	1.17
SB8065	SB8065G	3 X 2 1/2	54	92	0.84
SB9450	SB9450G	4 X 2	61	115	2.63
SB9465	SB9465G	4 X 2 1/2	61	115	2.21
SB9480	SB9480G	4 X 3	61	115	1.92

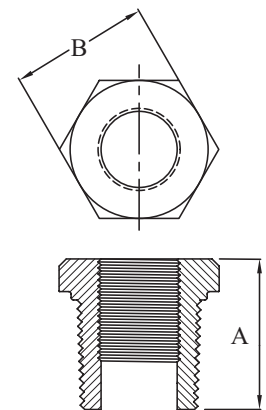

PEAL® Black & Galvanised Mild Steel Equal Tee



Black & Galvanised Mild Steel Equal Tee						
AAP CODE		IMPERIAL SIZE	A	C	D	APPROX (KG/PC)
BLACK	GALVANISED					
ST06	ST06G	1/8	46	20	33	0.11
ST08	ST08G	1/4	46	20	33	0.08
ST10	ST10G	3/8	48	21	35	0.09
ST15	ST15G	1/2	63	30	46	0.23
ST20	ST20G	3/4	71	35	51	0.31
ST25	ST25G	1	88	43	65	0.55
ST32	ST32G	1 1/4	106	51	75	0.72
ST40	ST40G	1 1/2	108	58	83	1.00
ST50	ST50G	2	131	71	101	1.57
ST65	ST65G	2 1/2	151	84	118	1.95
ST80	ST80G	3	178	99	135	3.09
ST94	ST94G	4	233	124	174	5.63

PEAL® Black & Galvanised Mild Steel Reducing Tee



Black & Galvanised Mild Steel Reducing Tee							
AAP CODE		IMPERIAL SIZE	A	C	D	E	APPROX (KG/PC)
BLACK	GALVANISED						
ST1008	ST1008G	3/8 X 1/4	49	24	20	38	0.12
ST1508	ST1508G	1/2 X 1/4	62	27	27	46	0.21
ST1510	ST1510G	1/2 X 3/8	62	27	27	46	0.20
ST2010	ST2010G	3/4 X 3/8	63	33	27	52	0.25
ST2015	ST2015G	3/4 X 1/2	71	34	34	53	0.33
ST2515	ST2515G	1 X 1/2	89	42	42	65	0.65
ST2520	ST2520G	1 X 3/4	89	42	42	65	0.61
ST3220	ST3220G	1 1/4 X 3/4	105	51	51	77	0.98
ST3225	ST3225G	1 1/4 X 1	105	51	51	77	0.85
ST4015	ST4015G	1 1/2 X 1/2	77	56	26	82	0.57
ST4020	ST4020G	1 1/2 X 3/4	82	56	32	82	0.62
ST4025	ST4025G	1 1/2 X 1	91	56	39	82	0.69
ST4032	ST4032G	1 1/2 X 1 1/4	98	56	49	87	0.83
ST5015	ST5015G	2 X 1/2	82	68	26	96	0.71
ST5020	ST5020G	2 X 3/4	88	68	32	100	0.79
ST5025	ST5025G	2 X 1	100	68	39	97	0.91
ST5032	ST5032G	2 X 1 1/4	131	70	70	100	2.03
ST5040	ST5040G	2 X 1 1/2	133	70	70	101	1.94
ST6550	ST6550G	2 1/2 X 2	133	84	68	117	1.68
ST8050	ST8050G	3 X 2	145	98	68	140	2.34
ST8065	ST8065G	3 X 2 1/2	183	96	85	140	2.96
ST9480	ST9480G	4 X 3	190	124	98	168	4.05



PEAL® Black & Galvanised Mild Steel Square Head Plug

Black & Galvanised Mild Steel Square Head Plug					
AAP CODE		IMPERIAL SIZE	A	C	APPROX (KG/PC)
BLACK	GALVANISED				
SPSQ06	SPSQ06G	1/8	15	6	0.01
SPSQ08	SPSQ08G	1/4	17	8	0.01
SPSQ10	SPSQ10G	3/8	22	11	0.02
SPSQ15	SPSQ15G	1/2	23	12	0.04
SPSQ20	SPSQ20G	3/4	27	19	0.08
SPSQ25	SPSQ25G	1	33	19	0.15
SPSQ32	SPSQ32G	1 1/4	41	22	0.33
SPSQ40	SPSQ40G	1 1/2	47	27	0.44
SPSQ50	SPSQ50G	2	47	32	0.70

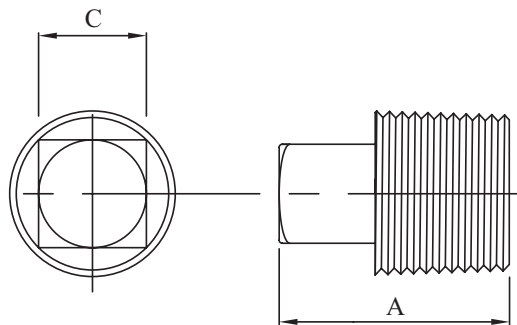

PEAL® Black & Galvanised Mild Steel Hexagon Plug

Black & Galvanised Mild Steel Hexagon Plug					
AAP CODE		IMPERIAL SIZE	ACROSS FLATS	B	APPROX. (KG/PC)
BLACK	GALVANISED		A		
SP06	SP06G	1/8	11.0	16.7	0.01
SP08	SP08G	1/4	16.0	19.8	0.02
SP10	SP10G	3/8	19.0	21.4	0.04
SP15	SP15G	1/2	22.2	27.0	0.07
SP20	SP20G	3/4	27.0	28.6	0.12
SP25	SP25G	1	35.0	30.9	0.20
SP32	SP32G	1 1/4	47.2	36.5	0.41
SP40	SP40G	1 1/2	52.1	38.1	0.55
SP50	SP50G	2	61.3	41.3	0.88
SP65	SP65G	2 1/2	79.4	47.6	1.68
SP80	SP80G	3	92.1	54.0	2.56
SP94	SP94G	4	115.8	61.9	4.93

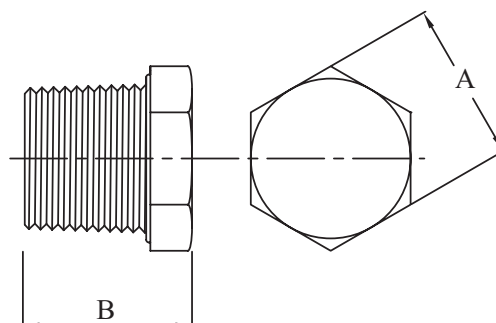

PEAL® Black Mild Steel Socket Head Plug



Black Mild Steel Socket Head Plug				
AAP CODE	IMPERIAL SIZE	A	C	APPROX (KG/PC)
SPS06	1/8	10	5	0.005
SPS08	1/4	14	6	0.01
SPS10	3/8	14	8	0.02
SPS15	1/2	15	10	0.03

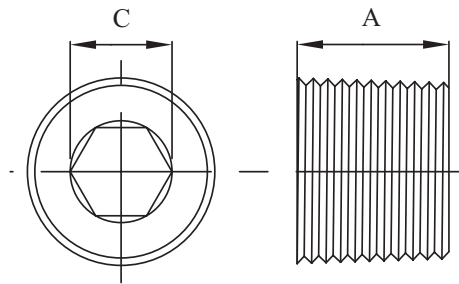

PEAL® Black & Galvanised Mild Steel Cap

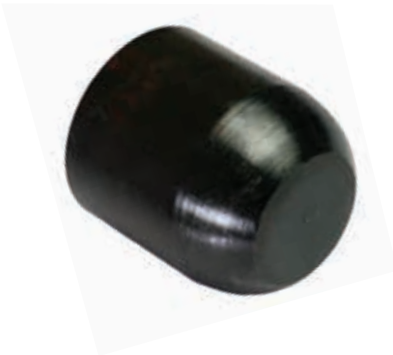

Black & Galvanised Mild Steel Cap					
AAP CODE		IMPERIAL SIZE	A	B	APPROX. (KG/PC)
BLACK	GALVANISED				
SC08	SC08G	1/4	23.8	19.1	0.03
SC10	SC10G	3/8	27.0	22.2	0.04
SC15	SC15G	1/2	34.9	28.6	0.10
SC20	SC20G	3/4	38.1	34.9	0.15
SC25	SC25G	1	44.5	41.3	0.24
SC32	SC32G	1 1/4	50.8	50.8	0.39
SC40	SC40G	1 1/2	54.0	57.2	0.43
SC50	SC50G	2	60.3	69.9	0.78
SC65	SC65G	2 1/2	66.7	88.9	1.40
SC80	SC80G	3	73.0	101.6	1.43
SC94	SC94G	4	85.7	128.6	3.17

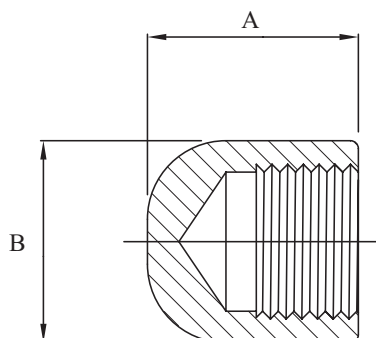

PEAL® Black & Galvanised Mild Steel Hexagon Backnut

Black & Galvanised Mild Steel Hexagon Backnut					
AAP CODE		IMPERIAL SIZE	B	C	APPROX. (KG/PC)
BLACK	GALVANISED				
SBN06	SBN06G	1/8	19.1	6.5	0.01
SBN08	SBN08G	1/4	22.2	7.0	0.01
SBN10	SBN10G	3/8	27.0	7.9	0.02
SBN15	SBN15G	1/2	30.0	9.0	0.03
SBN20	SBN20G	3/4	35.0	9.7	0.04
SBN25	SBN25G	1	47.2	10.3	0.08
SBN32	SBN32G	1 1/4	52.1	11.1	0.08
SBN40	SBN40G	1 1/2	61.3	11.9	0.13
SBN50	SBN50G	2	70.0	13.3	0.15
SBN80	SBN80G	3	100.0	21.5	0.45

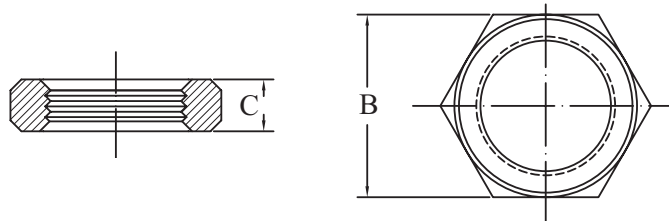
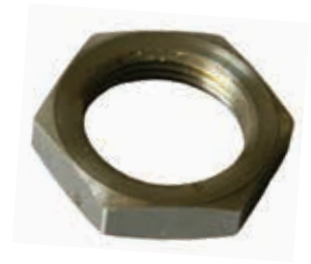

PEAL® Black & Galvanised Mild Steel Cross

Black & Galvanised Mild Steel Cross				
AAP CODE		IMPERIAL SIZE	A	APPROX (KG/PC)
BLACK	GALVANISED			
SCR08	SCR08G	1/4	47	0.15
SCR10	SCR10G	3/8	47	0.11
SCR15	SCR15G	1/2	64	0.22
SCR20	SCR20G	3/4	68	0.29
SCR25	SCR25G	1	86	0.49
SCR32	SCR32G	1 1/4	103	0.79
SCR40	SCR40G	1 1/2	105	0.97
SCR50	SCR50G	2	128	1.58

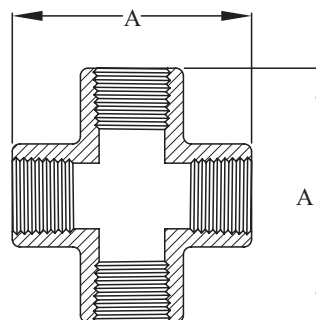

PEAL® Black & Galvanised Mild Steel M/M Bend 90 Degrees

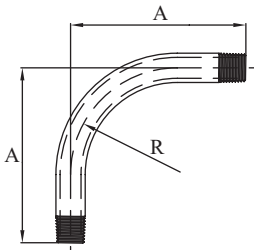

Black & Galvanised Mild Steel M/M Bend 90 Degrees					
AAP CODE		IMPERIAL SIZE	A	R	APPROX (KG/PC)
BLACK	GALVANISED				
SBD08	SBD08G	1/4	64	41	0.08
SBD10	SBD10G	3/8	73	48	0.12
SBD15	SBD15G	1/2	86	57	0.18
SBD20	SBD20G	3/4	102	73	0.29
SBD25	SBD25G	1	121	89	0.53
SBD32	SBD32G	1 1/4	146	108	0.83
SBD40	SBD40G	1 1/2	165	127	1.06
SBD50	SBD50G	2	203	159	1.85
SBD65	SBD65G	2 1/2	248	197	3.29
SBD80	SBD80G	3	292	232	5.22
SBD94	SBD94G	4	381	308	9.74

PEAL® Black & Galvanised Mild Steel M/M Bend 45 Degrees

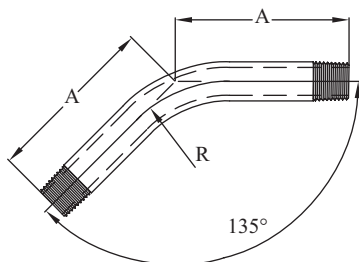

Black & Galvanised Mild Steel M/M Bend 45 Degrees					
AAP CODE		IMPERIAL SIZE	A	R	APPROX (KG/PC)
BLACK	GALVANISED				
SBDF15	SBDF15G	1/2	76	57	0.18
SBDF20	SBDF20G	3/4	89	73	0.32
SBDF25	SBDF25G	1	105	89	0.53
SBDF32	SBDF32G	1 1/4	127	108	0.84
SBDF40	SBDF40G	1 1/2	143	127	1.11
SBDF50	SBDF50G	2	175	159	1.94
SBDF65	SBDF65G	2 1/2	213	197	3.28
SBDF80	SBDF80G	3	248	232	5.02
SBDF94	SBDF94G	4	324	308	9.99



PEAL® Black Mild Steel Bevel End Bend 90 Degrees

Black Mild Steel Bevel End Bend 90 Degrees				
AAP CODE	IMPERIAL SIZE	APPROX A	APPROX R	APPROX (KG/PC)
SBDW15	1/2	86	57	0.18
SBDW20	3/4	102	73	0.31
SBDW25	1	121	89	0.58
SBDW32	1 1/4	146	108	0.89
SBDW40	1 1/2	165	127	1.14
SBDW50	2	203	159	1.87
SBDW65	2 1/2	248	197	3.30
SBDW80	3	292	232	5.16
SBDW94	4	381	308	9.97
SBDW96	6	622	440	28

* Bevel bends are subject to manufacturers specifications only. (Length and radius may vary)

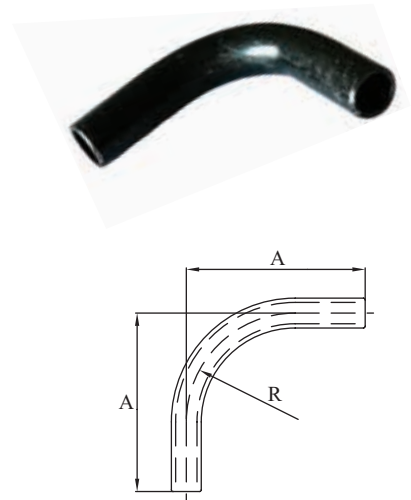

PEAL® Black & Galvanised Mild Steel Barrel Nipple

Black & Galvanised Mild Steel Barrel Nipple (Heavy Pipe)				
AAP CODE		IMPERIAL SIZE	A	APPROX. (KG/PC)
BLACK	GALVANISED			
SPN0640		1/8	40	0.03
SPN0660		1/8	60	0.04
SPN0680		1/8	80	0.06
SP0694		1/8	100	0.07
SPN08	SPN08G	1/4	40	0.02
SPN0860		1/4	60	0.03
SPN0880		1/4	80	0.04
SPN0894		1/4	100	0.05
SPN08120		1/4	120	0.06
SPN08140		1/4	140	0.07
SPN10	SPN10G	3/8	40	0.03
SPN1060		3/8	60	0.05
SPN1080		3/8	80	0.06
SPN1094		3/8	100	0.08
SPN10140		3/8	140	0.11
SPN1540		1/2	40	0.03
SPN15	SPN15G	1/2	51	0.04
SPN1560		1/2	60	0.05
SPN1580		1/2	80	0.06
SPN1594		1/2	100	0.08
SPN15120		1/2	120	0.09
SPN15140		1/2	140	0.11

Continues on the next page



PEAL® Black & Galvanised Mild Steel Barrel Nipple - Continued

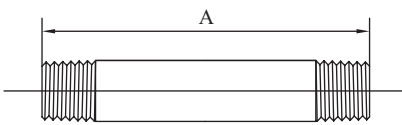

Black & Galvanised Mild Steel Barrel Nipple (Heavy Pipe) - Continued				
AAP CODE		IMPERIAL SIZE	A	APPROX. (KG/PC)
BLACK	GALVANISED			
SPN20	SPN20G	3/4	54	0.08
SPN2060		3/4	60	0.09
SPN2080		3/4	80	0.12
SPN2094		3/4	100	0.15
SPN20120		3/4	120	0.18
SPN20140		3/4	140	0.21
SPN25	SPN25G	1	60	0.16
SPN2580		1	80	0.21
SPN2594		1	100	0.27
SPN25120		1	120	0.32
SPN25140		1	140	0.37
SPN3260		1 1/4	60	0.16
SPN32	SPN32G	1 1/4	70	0.19
SPN3280		1 1/4	80	0.22
SPN3294		1 1/4	100	0.27
SPN32120		1 1/4	120	0.33
SPN32140		1 1/4	140	0.38
SPN4060		1 1/2	60	0.22
SPN40	SPN40G	1 1/2	70	0.26
SPN4080		1 1/2	80	0.30
SPN4094		1 1/2	100	0.37
SPN40120		1 1/2	120	0.45
SPN40140		1 1/2	140	0.52
SPN4098		1 1/2	200	0.74
SPN50	SPN50G	2	80	0.40
SPN5094		2	100	0.50
SPN50120		2	120	0.60
SPN50140		2	140	0.70
SPN6580		2 1/2	80	0.50
SPN65	SPN65G	2 1/2	89	0.56
SPN6594		2 1/2	100	0.63
SPN65120		2 1/2	120	0.76
SPN65140		2 1/2	140	0.88
SPN8080		3	80	0.69
SPN80	SPN80G	3	100	0.86
SPN80120		3	120	1.03
SPN80140		3	140	1.20
SPN9494		4	100	1.32
SPN94	SPN94G	4	114	1.50
SPN94120		4	120	1.58
SPN94140		4	140	1.84



PEAL® Mild Steel Close Nipple

Mild Steel Close Nipple (Heavy Pipe)				
AAP CODE		IMPERIAL SIZE	A	APPROX (KG/PC)
BLACK	GALVANISED			
SPN08CL	SPN08CLG *	1/4	27	0.01
SPN10CL	SPN10CLG *	3/8	28	0.02
SPN15CL	SPN15CLG *	1/2	37	0.03
SPN20CL	SPN20CLG *	3/4	40	0.06
SPN25CL	SPN25CLG *	1	46	0.16
SPN32CL	SPN32CLG *	1 1/4	51	0.2
SPN40CL	SPN40CLG *	1 1/2	51	0.2
SPN50CL	SPN50CLG *	2	60	0.3
SPN65CL	SPN65CLG *	2 1/2	69	0.35
SPN80CL	SPN80CLG *	3	75	0.64
SPN94CL	SPN94CLG *	4	75	0.85

* Medium Pipe

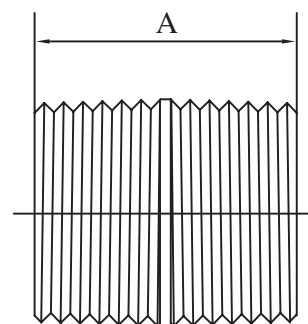

PEAL® Black Mild Steel Toe Nipple

Black Mild Steel Toe Nipple (Heavy Pipe)			
AAP CODE	IMPERIAL SIZE	A	APPROX. (KG/PC)
SPTOE1535	1/2	35	0.03
SPTOE2035	3/4	35	0.05
SPTOE2540	1	40	0.14
SPTOE3250	1 1/4	50	0.20
SPTOE4050	1 1/2	50	0.20
SPTOE5050	2	50	0.25
SPTOE6560	2 1/2	60	0.30
SPTOE8070	3	70	0.60
SPTOE9480	4	80	0.91

* Toe Nipples are subject to manufacturers specifications only.

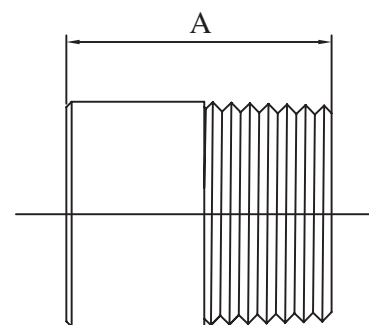

PEAL® Galvanised Mild Steel Combination Nipple

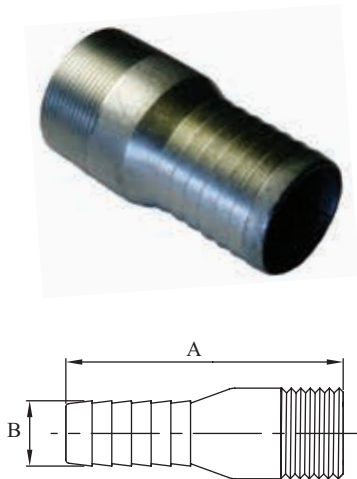

Galvanised Mild Steel Combination Nipple				
AAP CODE	IMPERIAL SIZE	A	B	APPROX. (KG/PC)
SCN15G	1/2	79	13.5	0.06
SCN20G	3/4	85	19.9	0.12
SCN25G	1	87	26.2	0.15
SCN32G	1 1/4	105	32.5	0.24
SCN40G	1 1/2	103	38.9	0.28
SCN50G	2	116	51.6	0.40
SCN65G	2 1/2	141	64.3	0.64
SCN80G	3	162	77.0	0.85
SCN94G	4	181	102.2	1.57
SCN96G	6	215	152.0	3.4

PEAL® Galvanised Mild Steel Hose Joiner

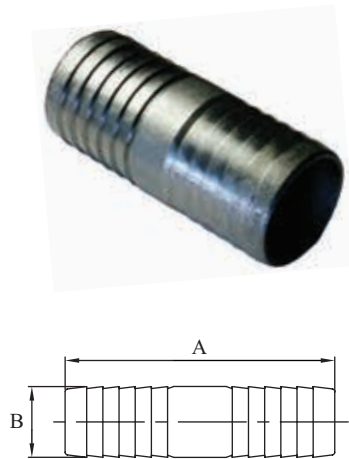

Galvanised Mild Steel Hose Joiner				
AAP CODE	IMPERIAL SIZE	A	B	APPROX. (KG/PC)
SHJ15G	1/2	85	13.5	0.06
SHJ20G	3/4	95	19.9	0.12
SHJ25G	1	100	26.2	0.15
SHJ32G	1 1/4	112	32.5	0.19
SHJ40G	1 1/2	115	38.9	0.23
SHJ50G	2	117	51.6	0.43
SHJ65G	2 1/2	139	64.3	0.77
SHJ80G	3	175	77.0	1.21
SHJ94G	4	216	102.2	2.00
SHJ96G	6	270	152.0	5.0

PEAL® Black Mild Steel Blank End



Black Mild Steel Blank End				
AAP CODE	SIZE IMPERIAL	Dia	A	APPROX. (KG/PC)
BE25	1	30	4.7	0.03
BE32	1 1/4	37	4.7	0.04
BE40	1 1/2	48	4.7	0.07
BE50	2	57	4.7	0.09
BE65	2 1/2	72	4.7	0.15
BE80	3	83	4.7	0.18
BE94	4	114	4.7	0.4
BE94U	4	108	4.7	0.4
BE95	5	126	4.7	0.48
BE96	6	160	4.7	0.75

PEAL® Black Mild Steel Imperial Shaft Collar

Black Mild Steel Imperial Shaft Collar					
AAP CODE	IMPERIAL SIZE	A	D	C	APPROX. (KG/PC)
C 1/4	1/4	15.9	9.5	3/16" BSW	0.01
C 5/16	5/16	19.2	10.9	3/16" BSW	0.01
C 3/8	3/8	22.2	11.1	1/4" BSW	0.02
C 1/2	1/2	25.4	12.7	1/4" BSW	0.03
C 5/8	5/8	25.6	12.7	1/4" BSW	0.03
C 3/4	3/4	34.9	17.5	5/16" BSW	0.08
C 7/8	7/8	38.1	19.1	5/16" BSW	0.1
C 1	1	34.9	19.1	5/16" BSW	0.1
C 1 1/8	1 1/8	47.6	22.2	5/16" BSW	0.18
C 1 1/4	1 1/4	50.8	22.2	3/8" BSW	0.2
C 1 3/8	1 3/8	57.2	22.2	3/8" BSW	0.21
C 1 1/2	1 1/2	57.2	22.2	3/8" BSW	0.22
C 1 5/8	1 5/8	60.5	25.4	3/8" BSW	0.28
C 1 3/4	1 3/4	63.5	25.4	3/8" BSW	0.31
C 1 7/8	1 7/8	63.5	25.4	3/8" BSW	0.3
C 2	2	76.2	25.4	1/2" BSW	0.51
C 2 1/2	2 1/2	88.9	31.7	1/2" BSW	0.71
C 2 3/4	2 3/4	95.3	31.7	1/2" BSW	0.65
C 3	3	101.6	31.7	1/2" BSW	0.84
C 3 1/4	3 1/4	108	31.7	1/2" BSW	0.96
C 3 1/2	3 1/2	114.3	31.7	1/2" BSW	1.02
C 4	4	127	31.7	1/2" BSW	1.07
C 4 1/2	4 1/2	139.9	29.3	1/2" BSW	1.04

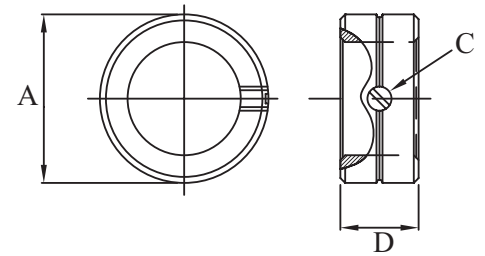

PEAL® Black Mild Steel Metric Shaft Collar

Black Mild Steel Metric Shaft Collar					
AAP CODE	SIZE METRIC	A	D	C	APPROX. (KG/PC)
C10	10	22.2	11.1	1/4" BSW	0.02
C12	12	25.4	12.7	1/4" BSW	0.03
C16	16	28.6	12.7	1/4" BSW	0.03
C20	20	31.6	17.5	5/16" BSW	0.08
C22	22	38.1	19.0	5/16" BSW	0.1
C25	25	41.3	19.0	5/16" BSW	0.11
C30	30	50.8	22.2	3/8" BSW	0.21
C33	33	50.8	22.2	3/8" BSW	0.18
C35	35	54.0	22.2	3/8" BSW	0.21
C39	39	57.2	22.2	3/8" BSW	0.21
C40	40	57.2	22.2	3/8" BSW	0.21
C45	45	63.5	27.0	3/8" BSW	0.29
C50	50	76.2	27.0	1/2" BSW	0.51

